

Power Line (Intrasite) HEMP Filters

MIL-STD-188-125-1 and MIL-STD-188-125-2 compliant

Enclosure

- ◆ Modified NEMA 1 type enclosure
- ◆ Cabinets: Stainless steel construction
- ◆ Stand alone filters and inserts: Cold rolled steel construction with a corrosion resistant plating
- ◆ Epoxy paint optional
- ◆ Shielding effectiveness on clean side greater than 100 dB from 14 kHz to 10 GHz
- ◆ Dual removable access covers.

Specifications

- ◆ Voltage Rating 277/480 VAC @ 60 Hz
- ◆ Current Rating 5 through 150 amperes
- ◆ HEMP Compliance Per MIL-STD-188-125-1 and MIL-STD-188-125-2 as Power Line (Intrasite) point of entry filter for short (E1) and intermediate (E2) pulses.
- ◆ Insertion Loss Standard performance (curve 1) or high performance (curve 2) per MIL-STD-220
- ◆ Leakage Current <10% of rated current 10 through 150 amperes, <1 amp for 5 amp filters
- ◆ Insulation Resistance Per MIL-PRF-15733, prior to discharge resistor installation.
- ◆ Dielectric Withstanding Voltage 2250 VDC line-to-chassis per MIL-STD-202, Method 301 prior to surge arrestor and discharge resistor installation
- ◆ Voltage Drop Less than 1% of rated voltage per paragraph 4.6.8 of MIL-PRF-15733
- ◆ Voltage Discharge Discharge to less than 30 Volts within 30s after removal of power
- ◆ Operating Temperature -40° C to +65° C
- ◆ Storage Temperature -55° C to +105° C

Features

- ◆ Inductive input
- ◆ Individually Filtered Lines
- ◆ Surge arrestors V481BA60 included
- ◆ Custom options available

Curve 1, Standard Performance Minimum Insertion Loss

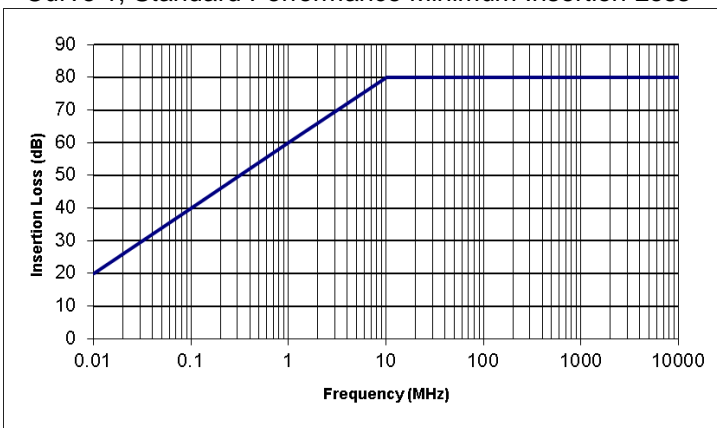

Frequency	I.L. (Minimum)
10 kHz	20 dB
100 kHz	40 dB
1 MHz	60 dB
10 MHz to 10 GHz	80 dB

Curve 2, High Performance Minimum Insertion Loss

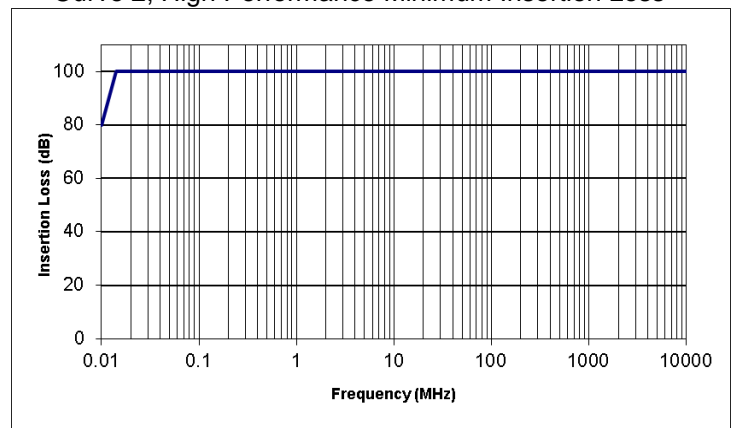

Frequency	I.L. (Minimum)
14 kHz to 10 GHz	100 dB

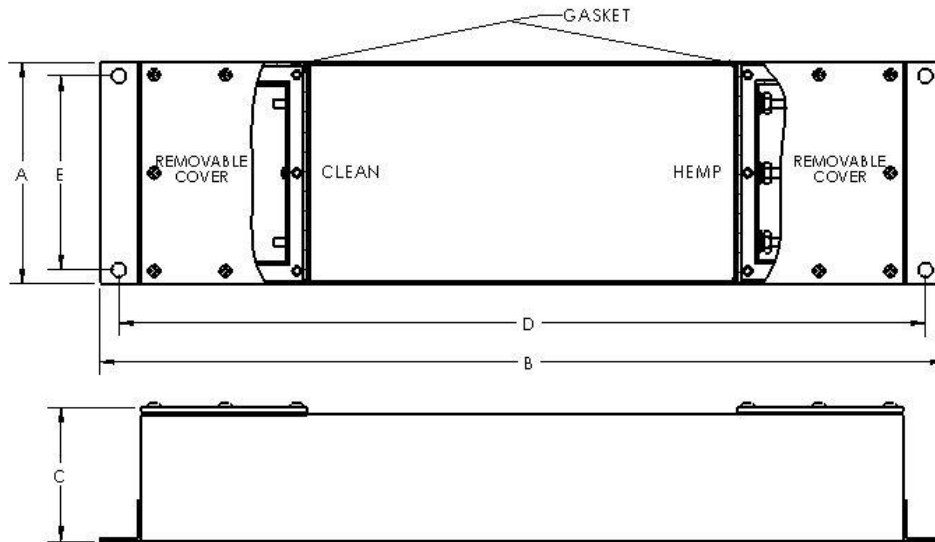

Figure 1, Stand Alone Filters 5 through 30 Amp

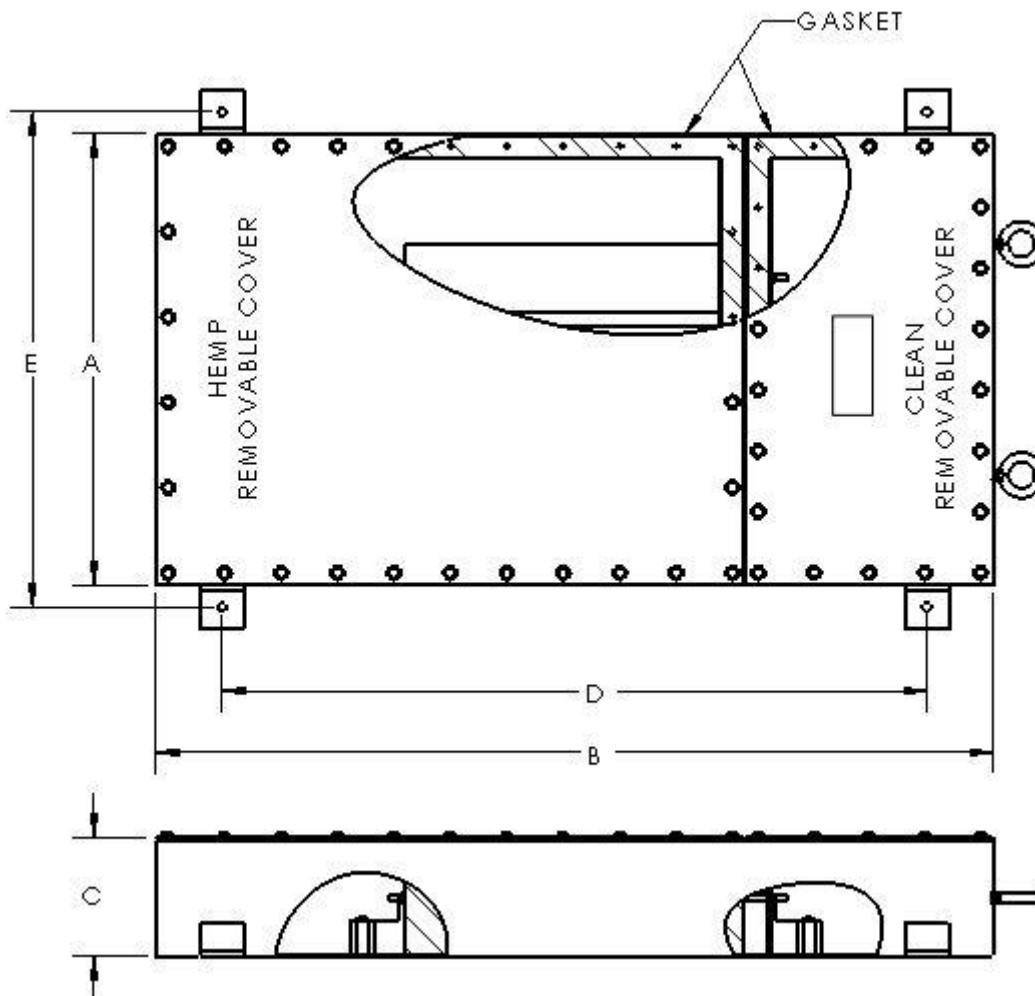

Figure 2, Cabinet with Filter Inserts, 60 - 150 Amp

Stand Alone Filters (Figure 1), 5 through 30 amp

Part Number	Current	Number of Circuits	Dimensions					Weight Estimated
			A	B	C	D	E	
Curve 1, Standard Performance Insertion Loss								
A-10540	5 amperes	2	9.0	30.0	5.5	29.0	8.0	50 Lbs.
A-10541		3	13.5	30.0	5.5	29.0	12.5	75 Lbs.
A-10542		4	18.0	30.0	5.5	29.0	17.0	105 Lbs.
A-10543	10 amperes	2	9.0	30.0	5.5	29.0	8.0	60 Lbs.
A-10544		3	13.5	30.0	5.5	29.0	12.5	90 Lbs.
A-10545		4	18.0	30.0	5.5	29.0	17.0	120 Lbs.
A-10546	20 amperes	2	12.0	31.0	5.5	30.0	11.0	70 Lbs.
A-10547		3	18.0	31.0	5.5	30.0	17.0	100 Lbs.
A-10548		4	24.0	31.0	5.5	30.0	23.0	135 Lbs.
A-10549	30 amperes	2	12.0	31.0	5.5	30.0	11.0	80 Lbs.
A-10550		3	18.0	31.0	5.5	30.0	17.0	115 Lbs.
A-10551		4	24.0	31.0	5.5	30.0	23.0	155 Lbs.
Curve 2, High Performance Insertion Loss								
A-10561	5 amperes	2	9.0	36.0	5.5	35.0	8.0	75 Lbs.
A-10562		3	13.5	36.0	5.5	35.0	12.5	110 Lbs.
A-10563		4	18.0	36.0	5.5	35.0	17.0	145 Lbs.
A-10564	10 amperes	2	9.0	36.0	5.5	35.0	8.0	85 Lbs.
A-10565		3	13.5	36.0	5.5	35.0	12.5	125 Lbs.
A-10566		4	18.0	36.0	5.5	35.0	17.0	165 Lbs.
A-10567	20 amperes	2	12.0	37.0	5.5	36.0	11.0	100 Lbs.
A-10568		3	18.0	37.0	5.5	36.0	17.0	155 Lbs.
A-10569		4	24.0	37.0	5.5	36.0	23.0	205 Lbs.
A-10570	30 amperes	2	12.0	37.0	5.5	36.0	11.0	115 Lbs.
A-10571		3	18.0	37.0	5.5	36.0	17.0	175 Lbs.
A-10572		4	24.0	37.0	5.5	36.0	23.0	235 Lbs.

Dimensions are in inches unless otherwise specified.
 Specifications subject to change

Cabinet with Filter Inserts (Figure 2), 60 through 150 amp

Part Number	Current	Number of Circuits	Dimensions					Weight Estimated
			A	B	C	D	E	
Curve 1, Standard Performance Insertion Loss								
A-10552	60 amperes	2	16.0	40.0	9.0	34.0	14.0	160 Lbs.
A-10553		3	24.0	40.0	9.0	34.0	22.0	210 Lbs.
A-10554		4	30.0	40.0	9.0	34.0	28.0	260 Lbs.
A-10555	100 amperes	2	16.0	40.0	9.0	34.0	14.0	165 Lbs.
A-10556		3	24.0	40.0	9.0	34.0	22.0	220 Lbs.
A-10557		4	30.0	40.0	9.0	34.0	28.0	270 Lbs.
A-10558	150 amperes	2	16.0	44.0	12.0	38.0	14.0	215 Lbs.
A-10559		3	24.0	44.0	12.0	38.0	22.0	305 Lbs.
A-10560		4	30.0	44.0	12.0	38.0	28.0	395 Lbs.
Curve 2, High Performance Insertion Loss								
A-10573	60 amperes	2	16.0	46.0	9.0	40.0	14.0	180 Lbs.
A-10574		3	24.0	46.0	9.0	40.0	22.0	240 Lbs.
A-10575		4	30.0	46.0	9.0	40.0	28.0	300 Lbs.
A-10576	100 amperes	2	16.0	46.0	9.0	40.0	14.0	190 Lbs.
A-10577		3	24.0	46.0	9.0	40.0	22.0	250 Lbs.
A-10578		4	30.0	46.0	9.0	40.0	28.0	310 Lbs.
A-10579	150 amperes	2	16.0	50.0	12.0	44.0	14.0	245 Lbs.
A-10580		3	24.0	50.0	12.0	44.0	22.0	350 Lbs.
A-10581		4	30.0	50.0	12.0	44.0	28.0	450 Lbs.